

File Location: C:\DEN\Projects\5087-02-RRWD\_Overall\_East\Projects\1240-Couplet\_Roadway\_Design\Design\Exhibits\2022-129\_Badger\_Gulch\_Regional\_Trail\_Exhibit.dwg Plot Date: 3/10/2023 12:37 PM Last Saved By: TVANGORDON

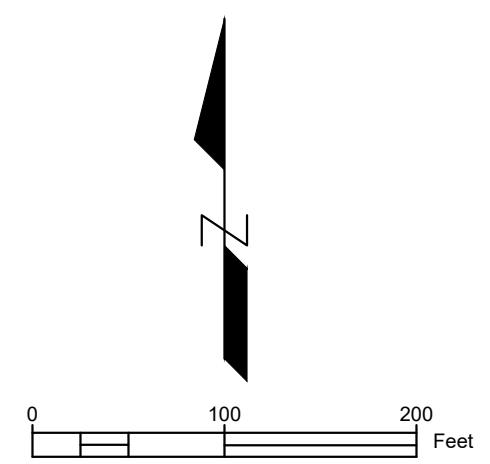

<b>RIDGEGATE EAST BADGER GULCH REGIONAL TRAIL</b>		DATE: 03/10/2023
		SHEET: 1 OF 3

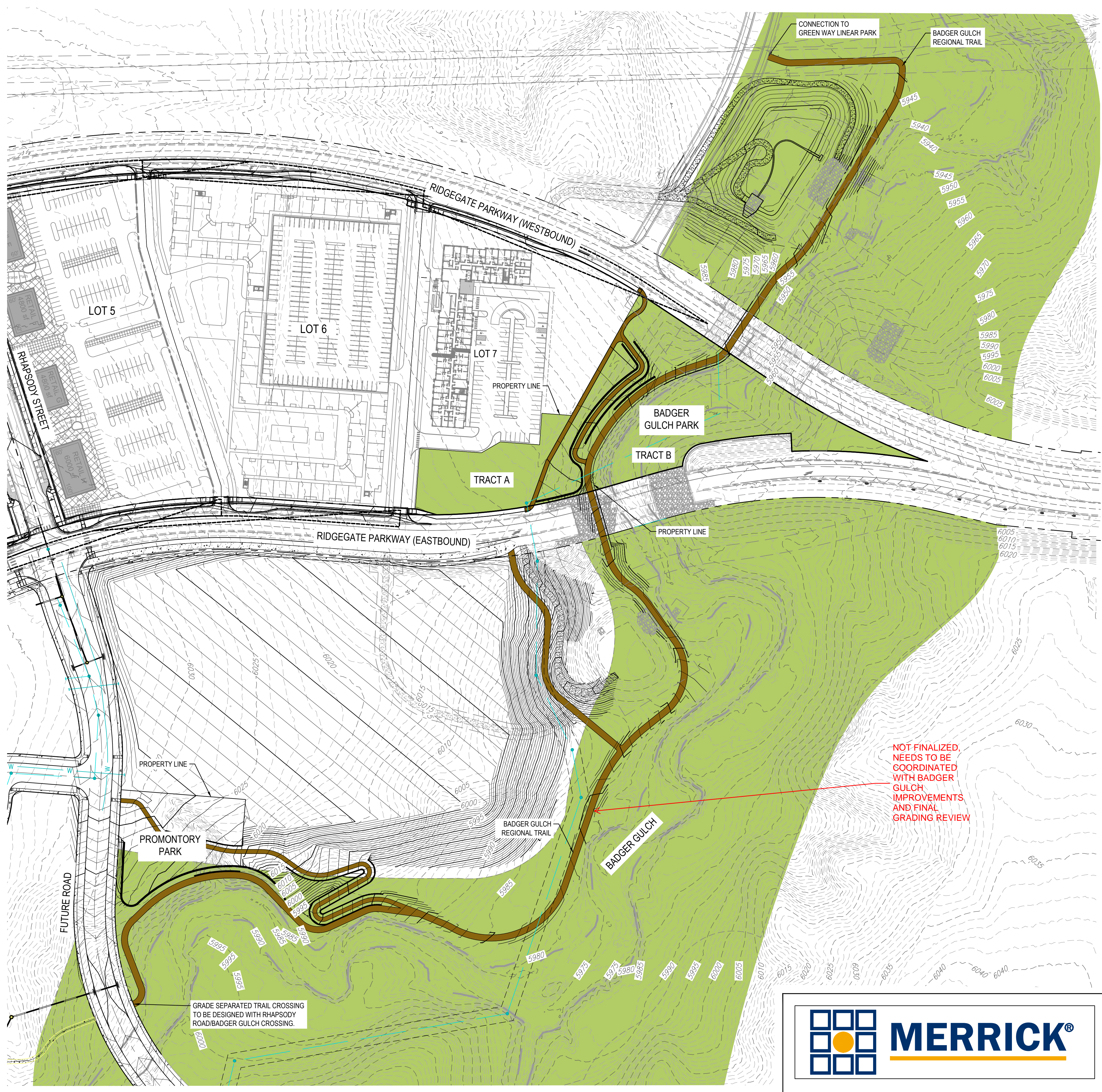

File Location: D:\DEN\Projects\5087-02-RRWD Overall East\Projects\1240-Couplet Roadway Design\Design\Exhibits\2022-1129 Badger Gulch Regional Trail Exhibit.dwg Plot Date: 3/10/2023 12:37 PM Last Saved By: TVANGORDON

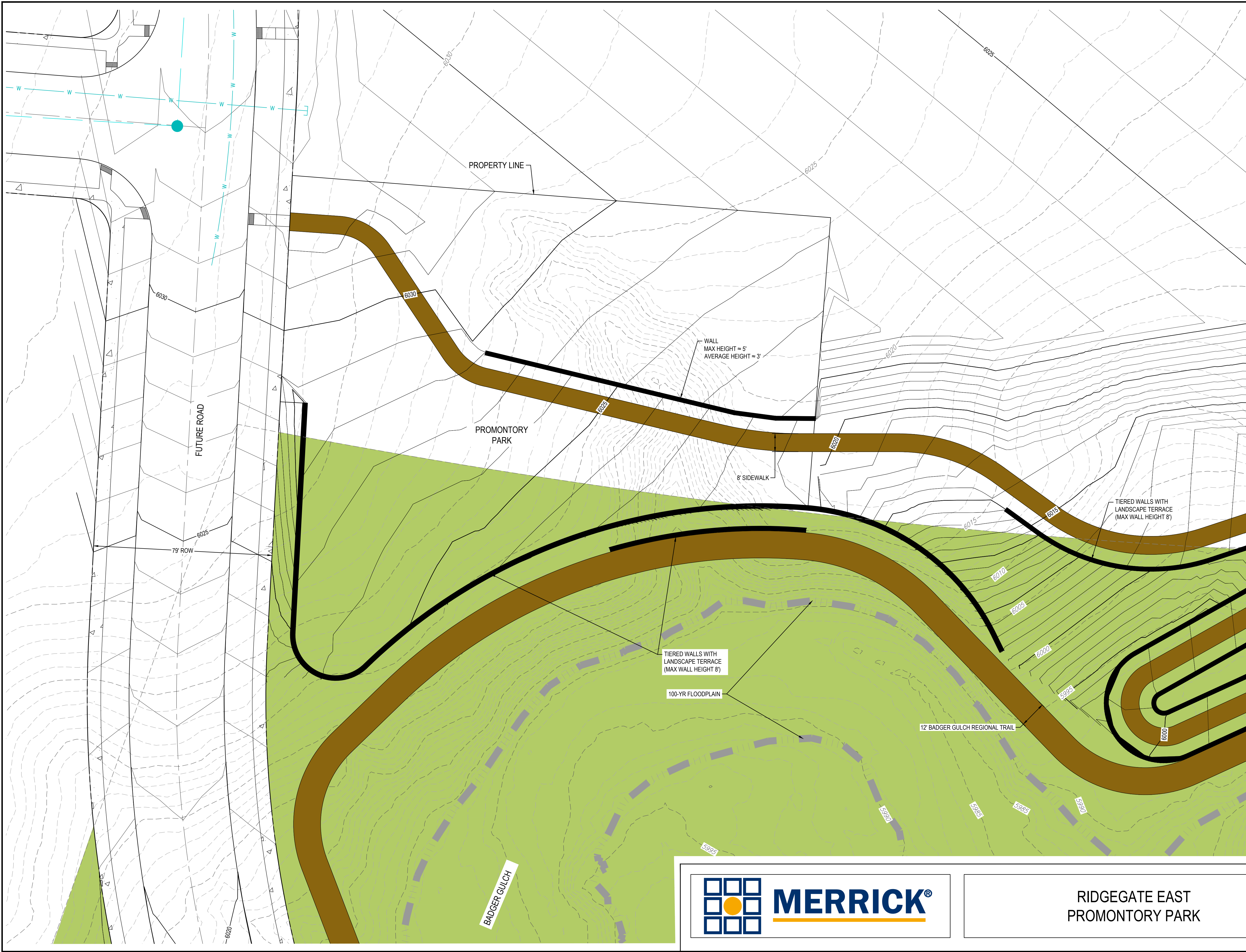

**PARK AND REGIONAL TRAIL NOTES:**

1. THE PROPOSED WALLS ARE CONCEPTUAL AND FOR REFERENCE ONLY.
2. WALL HEIGHTS WILL VARY WITH FINAL DESIGN. THE MAXIMUM WALL HEIGHT SHALL BE 8 FEET. TIERED WALLS WITH LANDSCAPE TERRACE SHALL BE USED IN AREAS WHERE WALL HEIGHT WOULD EXCEED 8 FEET.
3. SEE THE RIDGEGATE EAST SUB-AREA FOR THE EAST VILLAGES FOR ADDITIONAL INFORMATION.

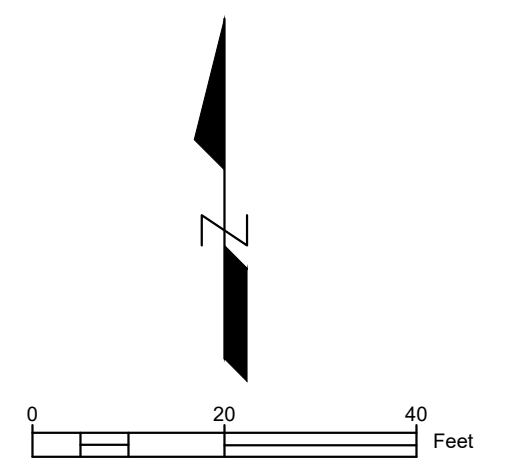

RIDGEGATE EAST  
PROMONTORY PARK

DATE: 03/10/2023  
SHEET: 2 OF 3



File Location: D:\DEN\Projects\5087-702-RRWD Overall East\Projects\1240-Couplet Roadway Design\Design\Exhibits\2022-121 Badger Gulch Park Exhibit.dwg Plot Date: 3/10/2023 12:38 PM Last Saved By: TVANGORDON



- PARK AND REGIONAL TRAIL NOTES:**
1. THE PROPOSED WALLS ARE CONCEPTUAL AND FOR REFERENCE ONLY.
  2. WALL HEIGHTS WILL VARY WITH FINAL DESIGN. THE MAXIMUM WALL HEIGHT SHALL BE 8 FEET. TIERED WALLS WITH LANDSCAPE TERRACE SHALL BE USED IN AREAS WHERE WALL HEIGHT WOULD EXCEED 8 FEET.
  3. SEE THE RIDGEGATE EAST SUB-AREA FOR THE EAST VILLAGES FOR ADDITIONAL INFORMATION.

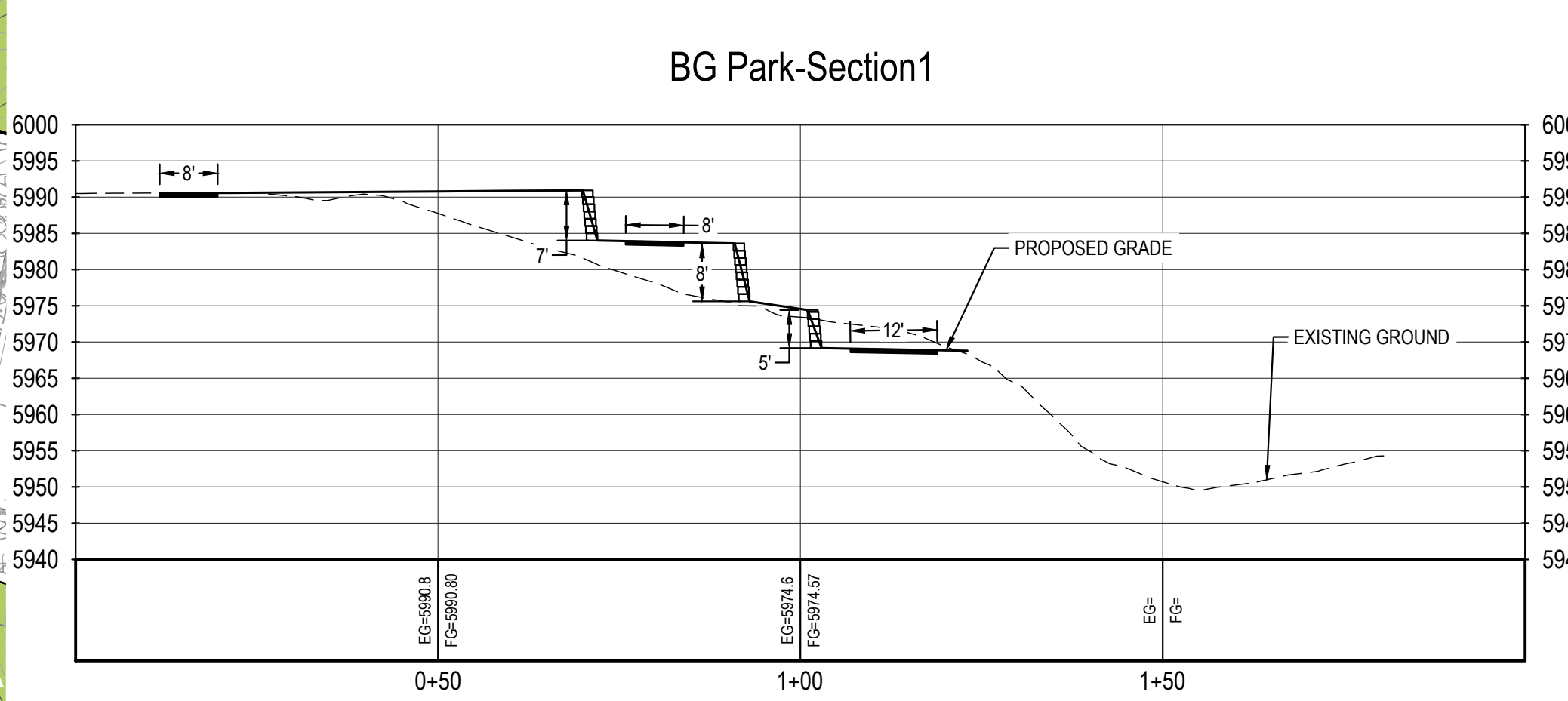

**RIDGEGATE EAST  
BADGER GULCH PARK**

DATE: 03/10/2023

SHEET: 3 OF 3