

LONE TREE RECREATION CENTER - PICKLEBALL

CITY OF LONE TREE, ADAMS COUNTY, STATE OF COLORADO

CONSTRUCTION PLANS

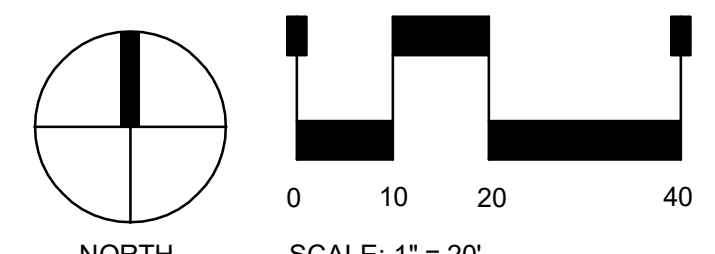

CAUTION - NOTICE TO CONTRACTOR

THE CONTRACTOR IS SPECIFICALLY CAUTIONED THAT THE LOCATION AND/OR ELEVATION OF EXISTING UTILITIES AS SHOWN ON THESE PLANS IS BASED ON RECORDS OF THE VARIOUS UTILITY COMPANIES AND, WHERE POSSIBLE, MEASUREMENTS TAKEN IN THE FIELD. THE INFORMATION IS NOT TO BE RELIED ON AS BEING EXACT OR COMPLETE. THE CONTRACTOR MUST CALL THE LOCAL UTILITY LOCATION CENTER AT LEAST 48 HOURS BEFORE ANY EXCAVATION TO REQUEST EXACT FIELD LOCATIONS OF THE UTILITIES. IT SHALL BE THE RESPONSIBILITY OF THE CONTRACTOR TO RELOCATE ALL EXISTING UTILITIES WHICH CONFLICT WITH THE PROPOSED IMPROVEMENTS SHOWN ON THE PLANS.

THE CONTRACTOR SHALL BE RESPONSIBLE FOR ANY DAMAGE TO EXISTING IMPROVEMENTS AND UTILITIES AND SHALL REPAIR ANY DAMAGE AT HIS EXPENSE.

LEGEND

	PROPERTY LINE
	EXISTING EASEMENT
	EXISTING CONCRETE
	EXISTING SIDEWALK
	EXISTING CURB & GUTTER
	EXISTING PARKING STRIPING
	CONCRETE PAVEMENT
	PROPOSED SIDEWALK
	PROPOSED CURB & GUTTER
	EXISTING MAJOR CONTOUR
	EXISTING MINOR CONTOUR
	PROPOSED MAJOR CONTOUR
	PROPOSED MINOR CONTOUR
	LIMIT OF DISTURBANCE

FOR ALL OTHER BMP SYMBOL DESIGNATIONS REFER TO LONE TREE GESC PLAN SHEET 1 OF 3.

GENERAL NOTES

- SITE IMPROVEMENTS ARE REQUIRED TO BE COVERED UNDER THE COLORADO DISCHARGE PERMIT SYSTEM (CDPS) GENERAL PERMIT COR400000 FOR STORMWATER DISCHARGES ASSOCIATED WITH CONSTRUCTION ACTIVITIES AS WELL AS CITY OF LONE TREE PERMIT COR-080016. STATE PERMIT APPLICATION SHALL BE MADE WITH THE COLORADO DEPARTMENT OF HEALTH & THE ENVIRONMENT THROUGH THE COLORADO ENVIRONMENTAL ONLINE SYSTEM (CEOS) ACCESSIBLE AT [HTTPS://CEOS.COLORADO.GOV/CO/CEOS/PUBLIC](https://ceos.colorado.gov/co/ceos/public). FOR CITY OF LONE TREE PERMIT INFORMATION: [HTTPS://CITYOFLONETREE.COM](https://cityoflonetree.com).
- PERMIT(S) COVERAGE REQUIRES THE DEVELOPMENT OF A STORMWATER MANAGEMENT PLAN (PLAN) IDENTIFYING AND ADDRESSING THE FOLLOWING ITEMS SPECIFIC TO THIS CONSTRUCTION ACTIVITY: (A) QUALIFIED STORMWATER MANAGER, (B) SPILL PREVENTION AND RESPONSE PLAN, (C) MATERIALS HANDLING, (D) POTENTIAL SOURCES OF POLLUTION, (E) IMPLEMENTATION OF CONTROL MEASURES, (F) SITE DESCRIPTION, (G) SITE MAP, (H) FINAL STABILIZATION AND LONG TERM STORMWATER MANAGEMENT, AND (I) SITE INSPECTION REPORTS.
- STERLING DESIGN ASSOCIATES, LLC HAS PREPARED AND MADE AVAILABLE A PLAN FOR THE OWNER PROVIDING FOR LOCAL JURISDICTIONAL ENTITLEMENT REVIEW. ONLY. THE PLAN IS INCOMPLETE WITHOUT ADDITIONAL INPUT FROM THE OPERATOR, INCLUDING, BUT NOT LIMITED TO, IDENTIFICATION OF THE PROJECT STORMWATER MANAGER AND INCLUSION OF A DETAILED CONSTRUCTION AND CONTROL MEASURE IMPLEMENTATION SCHEDULE. THE OPERATOR IS SOLELY RESPONSIBLE FOR COMPLETENESS AND IMPLEMENTATION OF A PLAN COMPLIANT WITH THE CDPS COR400000 AND LOCAL PERMIT REQUIREMENTS AT ALL TIMES OF SITE PERMIT COVERAGE.
- THE OWNER AND OPERATOR MUST IMPLEMENT THE PROVISIONS OF THE PLAN AS WRITTEN AND AS MAY BE UPDATED, FROM COMMENCEMENT OF CONSTRUCTION ACTIVITY UNTIL FINAL STABILIZATION IS COMPLETE.
- THE OPERATOR SHALL ENSURE ALL MATERIALS IMPORTED OR EXPORTED FROM THE SITE ARE PROPERLY SECURED AND COVERED TO PREVENT LOSS DURING TRANSPORT. ALL HAUL ROUTES SHALL BE DOCUMENTED WITHIN THE PLAN. ALL OFF-SITE SPOIL, BORROW, AND WASTE DISPOSAL FACILITIES SHALL BE PROPERLY PERMITTED FOR OPERATION.
- THE LANDSCAPE PLAN, L101, WILL ACT AS THE SWMP - FINAL PLAN. PLEASE REFER TO SAID PLAN FOR FINAL SITE STABILIZATION.
- FOR THE STAGE STORAGE AREA AND VEHICLE TRACKING CONTROL, THE CONTRACTOR SHALL UTILIZE THE EXISTING PAVEMENT TO THE GREATEST EXTENT PRACTICAL (PRE-ROLLED MATS, ETC.) OTHERWISE, REFER TO THE STANDARD DETAILS. NOTE: THE EXISTING PAVEMENT IS NOT ITSELF THE TRACKING CONTROL.
- THE CONTRACTOR MAY UTILIZE A PRE-FABRICATED CONCRETE WASHOUT BASIN IF IT IS BEING PLACED ON EXISTING PAVEMENT. OTHERWISE, REFER TO THE STANDARD DETAIL.

CONSTRUCTION SEQUENCE

- MEET ALL BMP PROTECTION, PRE-CONSTRUCTION MEETING, AND/OR OTHER CITY, COUNTY, STATE OR FEDERAL PERMIT REQUIREMENTS.
- INSTALL INITIAL, PERIMETER BMP CONTROLS (CF, VTC) PRIOR TO ANY LAND DISTURBANCE.
- CLEAR SITE AND BEGIN GRADING.
- BEGIN UTILITY CONSTRUCTION.
- ADJUST BMPS AS NECESSARY TO MAINTAIN EROSION AND SEDIMENTATION PROTECTION THROUGHOUT CONSTRUCTION. INSTALL ADDITIONAL BMPS (CWA, SSA, SCL, RS, ECB).
- COMPLETE GRADING AND BEGIN CURB AND GUTTER AND FLATWORK OPERATIONS. INSTALL ADDITIONAL BMPS.
- INSTALL FINAL LANDSCAPING. RE: LANDSCAPE PLAN, L101.
- REMOVE BMPS ONCE SITE REACHES FINAL STABILIZATION.

CITY OF LONE TREE
DATE
THESE CONSTRUCTION PLANS HAVE BEEN REVIEWED BY THE CITY OF LONE TREE FOR GRADING AND EROSION CONTROL ONLY.
ENGINEERING DIVISION ACCEPTANCE BLOCK



PREPARED UNDER THE DIRECT SUPERVISION OF RYAN J. LOFTUS, PE. COLORADO REGISTRATION NO. 48224. FOR & ON BEHALF OF STERLING DESIGN ASSOCIATES, LLC.

PRELIMINARY
NOT FOR CONSTRUCTION

STERLING DESIGN ASSOCIATES, LLC		
ISSUES & REVISIONS	NO.	DATE
DESCRIPTION:	1	DATE: -
DESCRIPTION:	2	DATE: -
DESCRIPTION:	3	DATE: -
DESCRIPTION:	4	DATE: -
DESCRIPTION:	5	DATE: -
DESCRIPTION:	6	DATE: -

DATE: 03/28/2022	SCALE: 1" = 20'
PROJECT MANAGER: JLW	PROJECT NO.:
DRAWN BY: RJL	DRAWING FILE:

PROJECT:
LONE TREE RECREATION CENTER PICKLE BALL COURTS
10249 RIDGEGATE CIRCLE
LONE TREE, CO 80124



CLIENT:
4810 E. COUNTY LINE RD.
LITTLETON, CO 80126
TEL: (303) 798-5131

SHEET TITLE:
STORMWATER MANAGEMENT PLAN (SWMP) - INITIAL
SHEET NUMBER:
C901

LONE TREE RECREATION CENTER - PICKLEBALL

CITY OF LONE TREE, ADAMS COUNTY, STATE OF COLORADO

CONSTRUCTION PLANS

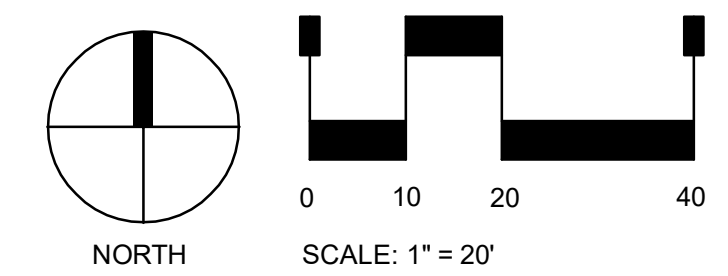
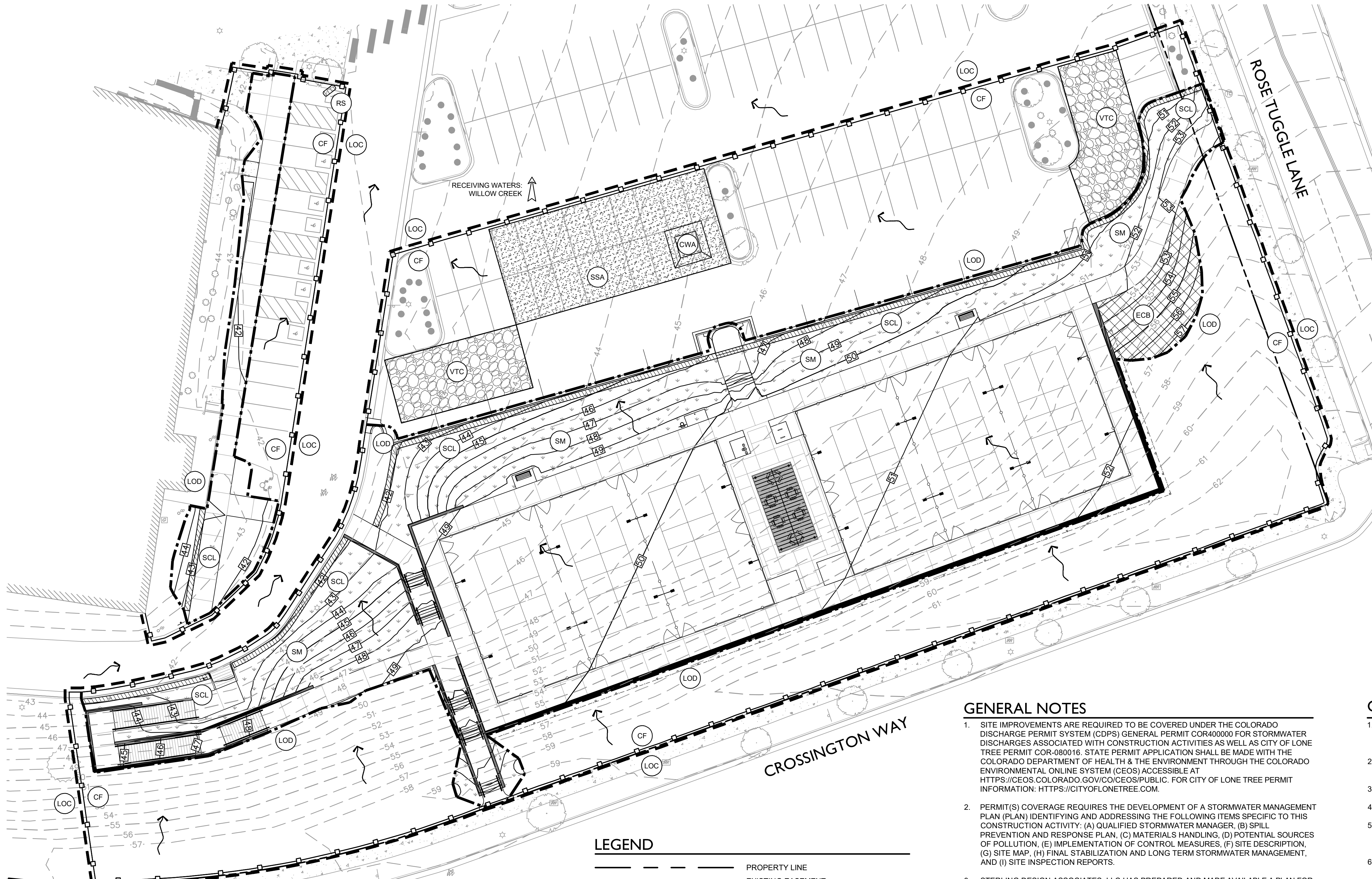

CAUTION - NOTICE TO CONTRACTOR

THE CONTRACTOR IS SPECIFICALLY CAUTIONED THAT THE LOCATION AND/OR ELEVATION OF EXISTING UTILITIES AS SHOWN ON THESE PLANS IS BASED ON RECORDS OF THE VARIOUS UTILITY COMPANIES AND, WHERE POSSIBLE, MEASUREMENTS TAKEN IN THE FIELD. THE INFORMATION IS NOT TO BE RELIED ON AS BEING EXACT OR COMPLETE. THE CONTRACTOR MUST CALL THE LOCAL UTILITY LOCATION CENTER AT LEAST 48 HOURS BEFORE ANY EXCAVATION TO REQUEST EXACT FIELD LOCATIONS OF THE UTILITIES. IT SHALL BE THE RESPONSIBILITY OF THE CONTRACTOR TO RELOCATE ALL EXISTING UTILITIES WHICH CONFLICT WITH THE PROPOSED IMPROVEMENTS SHOWN ON THE PLANS.

THE CONTRACTOR SHALL BE RESPONSIBLE FOR ANY DAMAGE TO EXISTING IMPROVEMENTS AND UTILITIES AND SHALL REPAIR ANY DAMAGE AT HIS EXPENSE.

LEGEND

	PROPERTY LINE
	EXISTING EASEMENT
	EXISTING CONCRETE
	EXISTING SIDEWALK
	EXISTING CURB & GUTTER
	EXISTING PARKING STRIPING
	CONCRETE PAVEMENT
	PROPOSED SIDEWALK
	PROPOSED CURB & GUTTER
	EXISTING MAJOR CONTOUR
	EXISTING MINOR CONTOUR
	PROPOSED MAJOR CONTOUR
	PROPOSED MINOR CONTOUR
	LIMIT OF DISTURBANCE

FOR ALL OTHER BMP SYMBOL DESIGNATIONS REFER TO LONE TREE GESC PLAN SHEET 1 OF 3.

GENERAL NOTES

- SITE IMPROVEMENTS ARE REQUIRED TO BE COVERED UNDER THE COLORADO DISCHARGE PERMIT SYSTEM (CDPS) GENERAL PERMIT COR400000 FOR STORMWATER DISCHARGES ASSOCIATED WITH CONSTRUCTION ACTIVITIES AS WELL AS CITY OF LONE TREE PERMIT COR-080016. STATE PERMIT APPLICATION SHALL BE MADE WITH THE COLORADO DEPARTMENT OF HEALTH & THE ENVIRONMENT THROUGH THE COLORADO ENVIRONMENTAL ONLINE SYSTEM (CEOS) ACCESSIBLE AT [HTTPS://CEOS.COLORADO.GOV/CO/CEOS/PUBLIC](https://ceos.colorado.gov/co/ceos/public). FOR CITY OF LONE TREE PERMIT INFORMATION: [HTTPS://CITYOFLONETREE.COM](https://cityoflonetree.com).
- PERMIT(S) COVERAGE REQUIRES THE DEVELOPMENT OF A STORMWATER MANAGEMENT PLAN (PLAN) IDENTIFYING AND ADDRESSING THE FOLLOWING ITEMS SPECIFIC TO THIS CONSTRUCTION ACTIVITY: (A) QUALIFIED STORMWATER MANAGER, (B) SPILL PREVENTION AND RESPONSE PLAN, (C) MATERIALS HANDLING, (D) POTENTIAL SOURCES OF POLLUTION, (E) IMPLEMENTATION OF CONTROL MEASURES, (F) SITE DESCRIPTION, (G) SITE MAP, (H) FINAL STABILIZATION AND LONG TERM STORMWATER MANAGEMENT, AND (I) SITE INSPECTION REPORTS.
- STERLING DESIGN ASSOCIATES, LLC HAS PREPARED AND MADE AVAILABLE A PLAN FOR THE OWNER PROVIDING FOR LOCAL JURISDICTIONAL ENTITLEMENT REVIEW. ONLY THE PLAN IS INCOMPLETE WITHOUT ADDITIONAL INPUT FROM THE OPERATOR, INCLUDING, BUT NOT LIMITED TO, IDENTIFICATION OF THE PROJECT STORMWATER MANAGER AND INCLUSION OF A DETAILED CONSTRUCTION AND CONTROL MEASURE IMPLEMENTATION SCHEDULE. THE OPERATOR IS SOLELY RESPONSIBLE FOR COMPLETENESS AND IMPLEMENTATION OF A PLAN COMPLIANT WITH THE CDPS COR400000 AND LOCAL PERMIT REQUIREMENTS AT ALL TIMES OF SITE PERMIT COVERAGE.
- THE OWNER AND OPERATOR MUST IMPLEMENT THE PROVISIONS OF THE PLAN AS WRITTEN AND AS MAY BE UPDATED, FROM COMMENCEMENT OF CONSTRUCTION ACTIVITY UNTIL FINAL STABILIZATION IS COMPLETE.
- THE OPERATOR SHALL ENSURE ALL MATERIALS IMPORTED OR EXPORTED FROM THE SITE ARE PROPERLY SECURED AND COVERED TO PREVENT LOSS DURING TRANSPORT. ALL HAUL ROUTES SHALL BE DOCUMENTED WITHIN THE PLAN. ALL OFF-SITE SPOIL, BORROW, AND WASTE DISPOSAL FACILITIES SHALL BE PROPERLY PERMITTED FOR OPERATION.
- THE LANDSCAPE PLAN, L101, WILL ACT AS THE SWMP - FINAL PLAN. PLEASE REFER TO SAID PLAN FOR FINAL SITE STABILIZATION.
- FOR THE STAGE STORAGE AREA AND VEHICLE TRACKING CONTROL, THE CONTRACTOR SHALL UTILIZE THE EXISTING PAVEMENT TO THE GREATEST EXTENT PRACTICAL (PRE-ROLLED MATS, ETC.) OTHERWISE, REFER TO THE STANDARD DETAILS. NOTE: THE EXISTING PAVEMENT IS NOT ITSELF THE TRACKING CONTROL.
- THE CONTRACTOR MAY UTILIZE A PRE-FABRICATED CONCRETE WASHOUT BASIN IF IT IS BEING PLACED ON EXISTING PAVEMENT. OTHERWISE, REFER TO THE STANDARD DETAIL.

CONSTRUCTION SEQUENCE

- MEET ALL BMP PROTECTION, PRE-CONSTRUCTION MEETING, AND/OR OTHER CITY, COUNTY, STATE OR FEDERAL PERMIT REQUIREMENTS.
- INSTALL INITIAL, PERIMETER BMP CONTROLS (CF, VTC) PRIOR TO ANY LAND DISTURBANCE.
- CLEAR SITE AND BEGIN GRADING.
- BEGIN UTILITY CONSTRUCTION.
- ADJUST BMPS AS NECESSARY TO MAINTAIN EROSION AND SEDIMENTATION PROTECTION THROUGHOUT CONSTRUCTION. INSTALL ADDITIONAL BMPS (CWA, SSA, SCL, RS, ECB).
- COMPLETE GRADING AND BEGIN CURB AND GUTTER AND FLATWORK OPERATIONS. INSTALL ADDITIONAL BMPS.
- INSTALL FINAL LANDSCAPING. RE: LANDSCAPE PLAN, L101.
- REMOVE BMPS ONCE SITE REACHES FINAL STABILIZATION.

CITY OF LONE TREE
DATE
THESE CONSTRUCTION PLANS HAVE BEEN REVIEWED BY THE CITY OF LONE TREE FOR GRADING AND EROSION CONTROL ONLY.
ENGINEERING DIVISION ACCEPTANCE BLOCK

STERLING DESIGN ASSOCIATES
Civil Engineers | Landscape Architects
2009 W. Littleton Blvd. #300 Littleton, CO 80120
303.794.4727 | www.SterlingDesignAssociates.com

PREPARED UNDER THE DIRECT SUPERVISION OF
RYAN J. LOFTUS, PE
COLORADO REGISTRATION NO. 48224
FOR & ON BEHALF OF STERLING DESIGN ASSOCIATES, LLC

PRELIMINARY
NOT FOR CONSTRUCTION

STERLING DESIGN ASSOCIATES, LLC

ISSUES & REVISIONS		
NO. 1	DATE: -	BY: -
DESCRIPTION: -		
NO. 2	DATE: -	BY: -
DESCRIPTION: -		
NO. 3	DATE: -	BY: -
DESCRIPTION: -		
NO. 4	DATE: -	BY: -
DESCRIPTION: -		
NO. 5	DATE: -	BY: -
DESCRIPTION: -		
NO. 6	DATE: -	BY: -
DESCRIPTION: -		

DATE: 03/28/2022	SCALE: 1" = 20'
PROJECT MANAGER: JLW	PROJECT NO.:
DRAWN BY: RJL	DRAWING FILE:

PROJECT:
LONE TREE RECREATION CENTER PICKLE BALL COURTS
10249 RIDGEGATE CIRCLE
LONE TREE, CO 80124



CLIENT:

4810 E. COUNTY LINE RD.
LITTLETON, CO 80126

TEL: (303) 798-5131

SHEET TITLE:
STORMWATER MANAGEMENT PLAN (SWMP) - INTERIM

SHEET NUMBER:

C902

