



CITY OF LONE TREE

SIGN DETAILS FOR RAISED MEDIANS NOSE

The following signage shall be placed at the “nose” on all raised median islands, unless otherwise directed by the City Public Works Department.



R4-7 over OM3-L



R4-8 over OM3-R



W12-1 over OM3-C



SELECT APPROPRIATE SIGNAGE FOR SPECIFIC SITE FROM ABOVE ALTERNATIVES

NOTE: If median width (back of curb to back of curb) is less than 4.0', R4-7c, R4-8c or W12-1c shall be used.

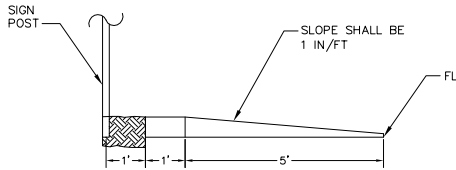

Sign Location Detail
NTS

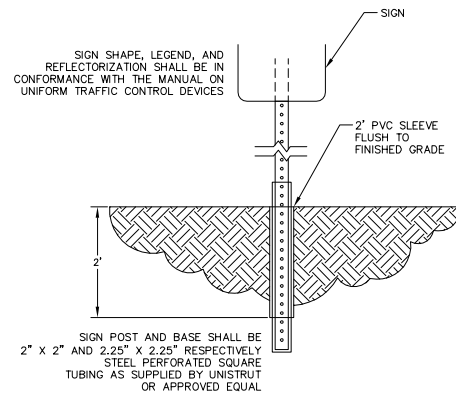
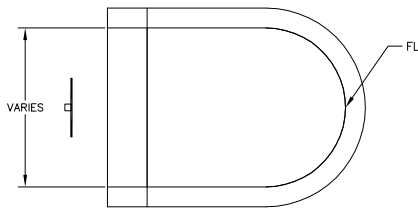

Sign Base Detail
NTS

NOTES:

1. All traffic control devices shall conform to the most recent version of the Federal Manual on Uniform Traffic Control Devices (MUTCD), the "Colorado Supplemental MUTCD" and the Douglas County "Road and Construction Standards Manual". Further specifications and illustrations are located in the Colorado Division of Highways "M and S Standards".
2. All newly installed traffic signs shall meet the minimum retro-reflectivity and illumination standards as set forth by the MUTCD (latest edition). These minimum requirements shall fall under the requirements of the two (2) year warranty period for new construction.
3. The contractor installing signs is responsible for locating and protecting all underground utilities. Lone Tree Public Works shall be contacted a minimum of 72 hours prior to installation at 303-662-8112.
4. Following installation, the contractor shall notify the City of Lone Tree Public Works Department, 303-662-8112. A field inspection of location and installation of all signs shall be performed by Public Works. All discrepancies identified during the field inspection must be corrected before the two-year warranty period will begin.